

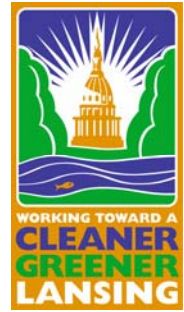

Virg Bernero, Mayor

**PUBLIC SERVICE
DEPARTMENT**

732 City Hall
124 West Michigan Avenue
Lansing, Michigan 48933
(517) 483-4455
FAX: (517) 483-6082
<http://publicservice.cityoflansingmi.com>



For Immediate Release
August 20, 2010

Primary Contact: Richard LaMay
517/483-6034
Secondary Contact: Mitch Whisler
517/483-4249

TRAFFIC ADVISORY

CSX RAILROAD TO CLOSE PENNSYLVANIA AVENUE AT RAILROAD TRACKS NORTH OF I-496 OVERPASS

The City of Lansing, Public Service Department announces that crews from CSX will be closing Pennsylvania Avenue to replace the railroad crossing between Euclid Place and Heald Place (north of I-496 overpass). This street closure is estimated to be in place for 3 to 5 days beginning early morning on Monday, August 23, 2010.

Although Pennsylvania Avenue will be closed at the railroad tracks, local access adjacent to the work area will be maintained. Destinations south of the railroad tracks may be accessed from the I-496 off ramps, while destinations north of the railroad tracks may be accessed from the Kalamazoo Street and / or Michigan Avenue intersection with Pennsylvania Avenue.

Suggested Detour Routes:

Northbound vehicles on Pennsylvania Avenue south of the CSX railroad crossing will be required to travel west on the I-496 excess road (St. Joseph Street) to Cedar Street, then north on Cedar Street to Kalamazoo Street, then travel west on Kalamazoo Street to return to Pennsylvania Avenue, or continue north on Cedar Street to Michigan Avenue then east on Michigan Avenue to return to Pennsylvania Avenue.

Southbound vehicles on Pennsylvania Avenue north of the CSX Rail Road Crossing will be required to either travel west on Kalamazoo Street to Cedar Street, then south on Cedar Street to the eastbound I-496 on ramp, then east to return to Pennsylvania Avenue.

Motorists are advised to use alternate routes and to expect delays.

#####



Virg Bernero, Mayor

PUBLIC SERVICE DEPARTMENT

732 City Hall
124 West Michigan Avenue
Lansing, Michigan 48933
(517) 483-4455
FAX: (517) 483-6082

<http://publicservice.cityoflansingmi.com>

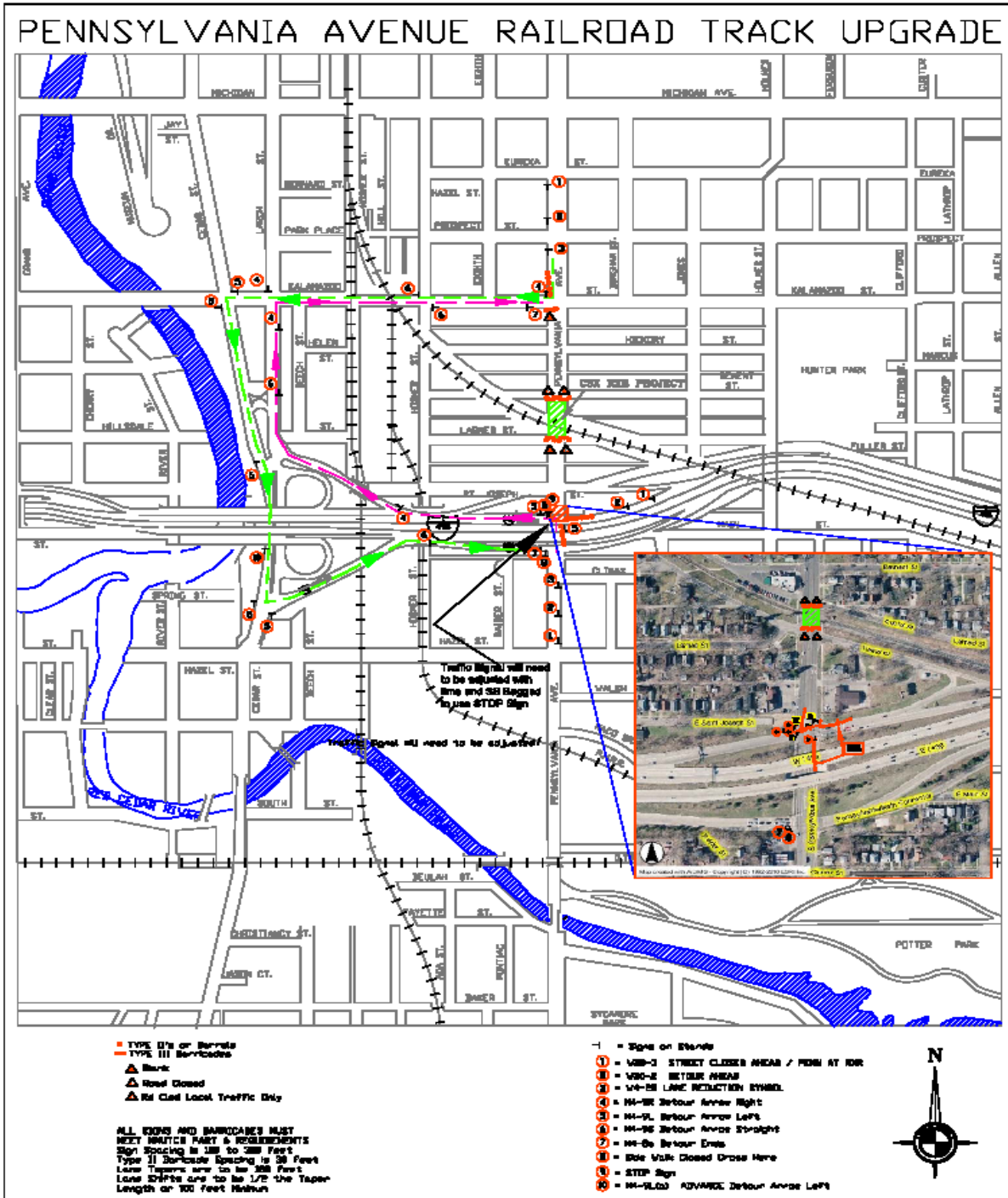
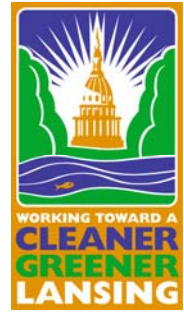

Color Map with Detour Routes can be found at www.lansingmi.gov